

円心ファンの作り方

①羽をしるしにそって土台にのり付けする

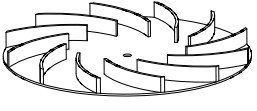

②ふたをのり付けする

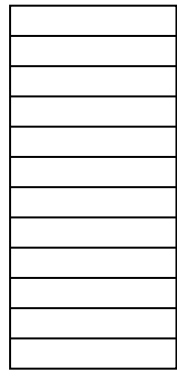
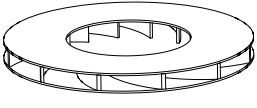

羽 (たて4mm・よこ22mm)

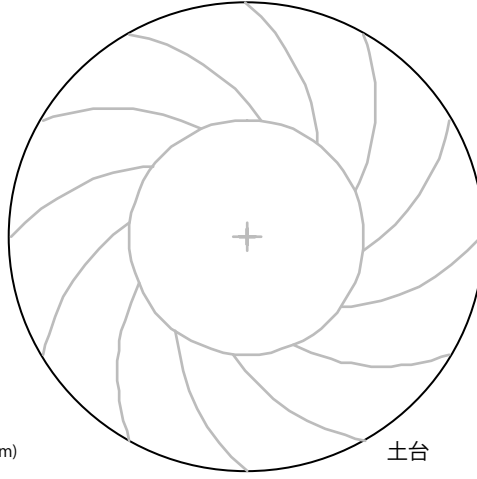

土台

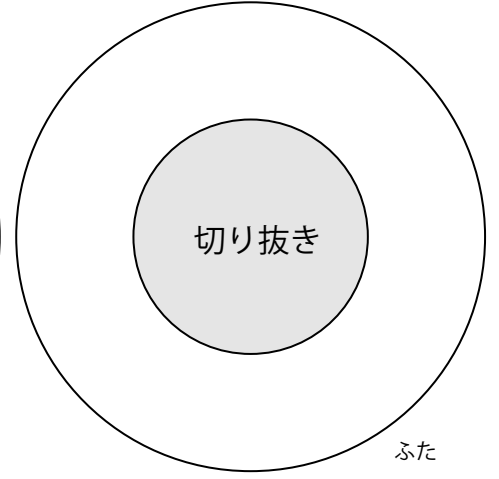

ふた

円心ファンの作り方

①羽をしるしにそって土台にのり付けする

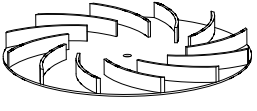

②ふたをのり付けする

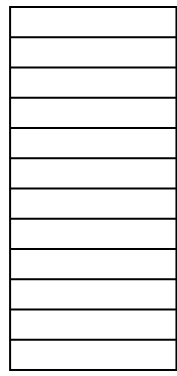
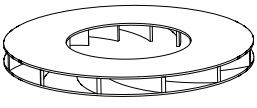

羽 (たて4mm・よこ22mm)

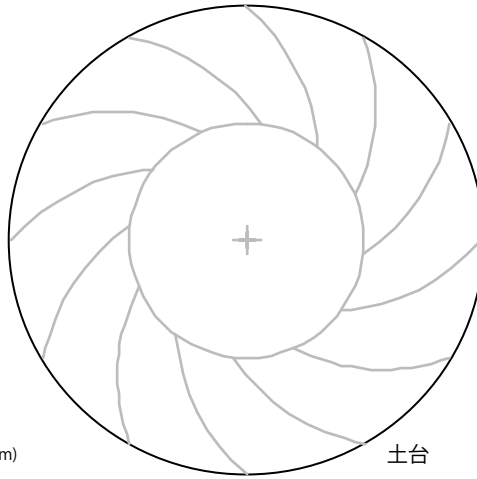

土台

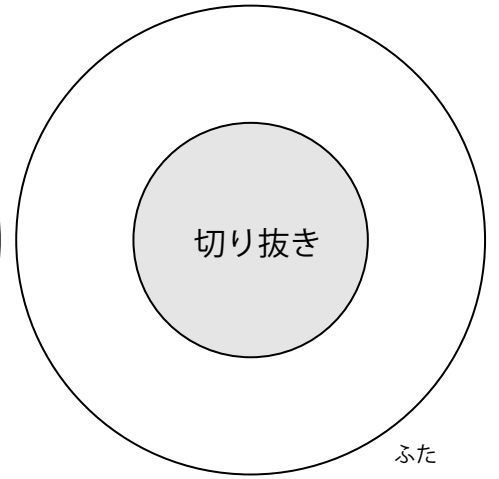

ふた

円心ファンの作り方

①羽をしるしにそって土台にのり付けする

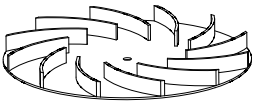

②ふたをのり付けする

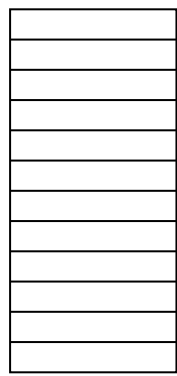
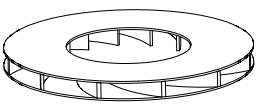

羽 (たて4mm・よこ22mm)

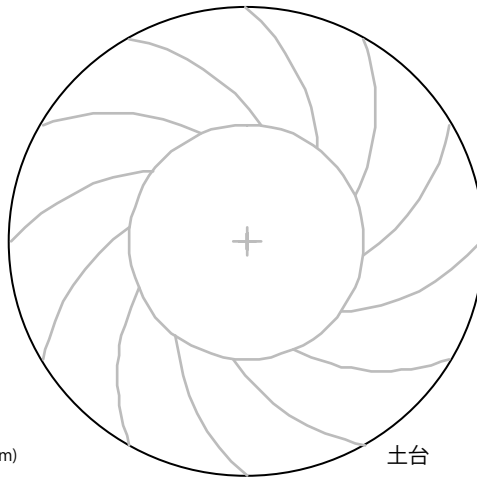

土台

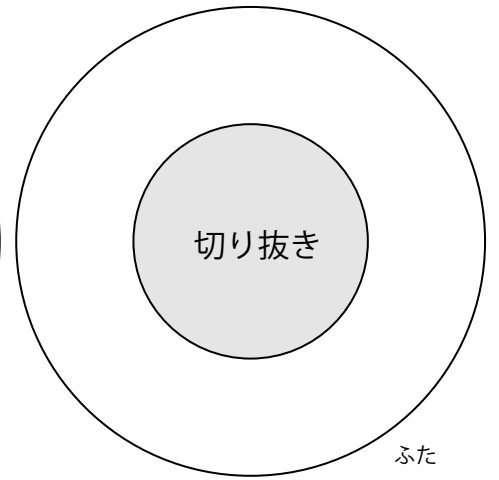

ふた

円心ファンの作り方

①羽をしるしにそって土台にのり付けする

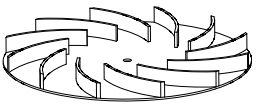

②ふたをのり付けする

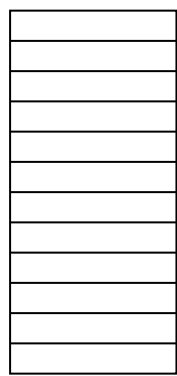
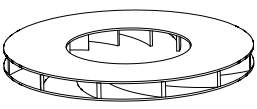

羽 (たて4mm・よこ22mm)

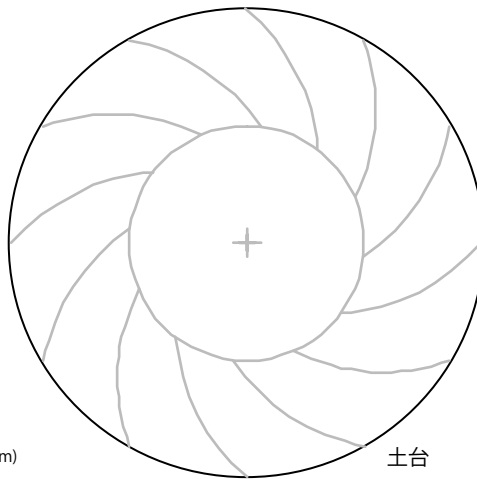

土台

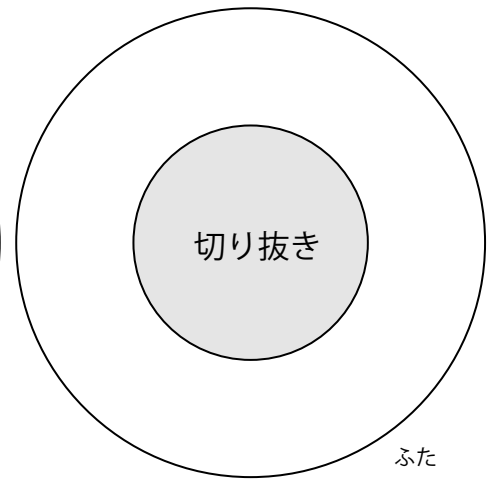

ふた